

Pos. Nr. Pos.no.	Beschreibung Description	Art.-Nr. Art.no.	Preisgruppe Price bracket
1	Gehäuse kpl. 2095 014-3 Body ass. loco no. 2095 014-3	143672	36
2	E-Lokführer Loco driver	110407	6
3	Griffstange lack. Hand-rail painted	142153	7
4	Lüftergitter Part set ventilator grills	142154	7
5	Führungsstange Hand-rail	142155	5
6	GF-Schraube M1,6x10 mm Self-tapping screw M1,6x10 mm	114881	3
7	Dachdeckel Roof cover	142190	6
8	Führerstand 1+2 Driver's cabs 1+2	143673	10
9	TS-Inneneinrichtung Part set of interior fittings	142129	9
10	TS-Schneepflug, Frontschürze Part set of snow plow, front skirt	142192	9
11	Stirnblech Front plate	142135	6
12	Stirngriffstange Vertical handrail	142136	6
13	E-Kabelanschluss Cable connection	143674	6
14	TS-Scheibenwischer Part set of windshield wipers	142986	8
15	TS - Fenster Part set of windows	142141	17
16	TS-Lichtleiter Part set of light conductor	142142	10
17	Feuerlöscher Fire extinguisher	135357	6
18	Lichtringe Light ring	139819	5
19	Platine kpl.mit LED-Platine PCB complete with LED-PCB	142144	21
20	Brückenstecker Connector	133241	10
21	Signalhorn Horn	143675	3
Sound			
22	Platine kpl.mit LED-Platine für So. PCB complete with LED-PCB	142159	22
23	Sounddecoder Sound-decoder	129000	39
24	Lautsprecher Loudspeaker	129524	14

Änderungen in Konstruktion und Ausführung vorbehalten
We reserve the right to change the construction and specification

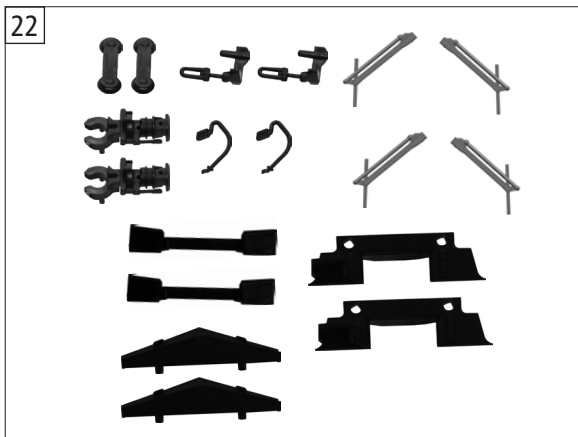
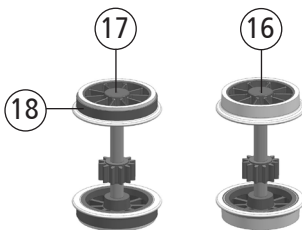
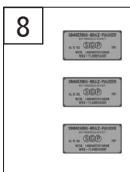
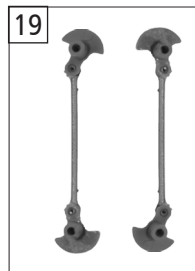
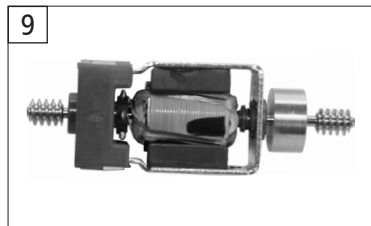
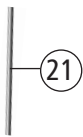
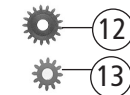
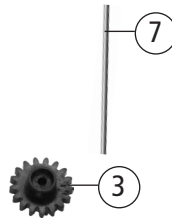
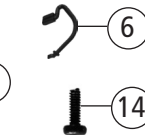
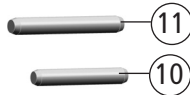
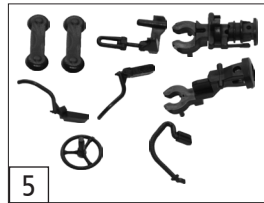
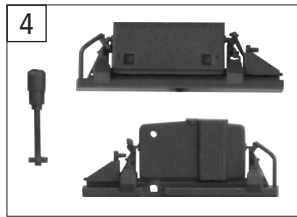
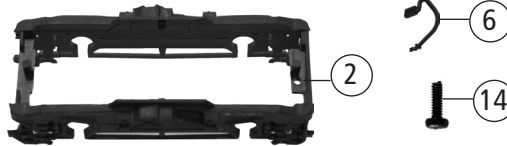

Pos. Nr. Pos.no.	Beschreibung Description	Art.-Nr. Art.no.	Preisgruppe Price bracket
1	Grundrahmen Basic frame	142189	17
2	DG - Blende Bogie - Blinds	142198	8
3	Zahnrad Z=17 – schwarz Gear wheel Z=17 – black	142157	4
4	TS - Tankdeckel Part set - Tank cover	143676	11
5	TS - Schlauch, Kupplung Part set - Hose, coupling	143677	8
6	Bremsschlauch Brake tube	142140	7
7	Rückstellfeder Retainer spring	142143	5
8	Tafelsatz Set of panels	143678	12
9	Motor m.Schwungm.+2Schn. Motor with flywheel	142145	30
10	Achse f. Zahnrad D=1 L=6,4 mm Axle for gear wheel D=1 L=6,4 mm	00730541	1
11	Achse D=2,1 L=8 mm Axle D=2,1 L=8 mm	142146	5
12	Untersetzungszahnrad Z=12/17 Reduction gear wheel Z=12/17	135806	5
13	Zwischenzahnrad Z=12 D=5,6 Intermediate gear wheel Z=12 D=5,6	112464	3
14	Schraube M1,5x5 mm Screw M1,5x5 mm	108137	3
15	Radkontakt Wheel contact	142147	7
16	Radsatz mit Zahnrad ohne Haftring Wheelset w. gear wheel w/o tract.tyre	142148	11
17	Radsatz mit Zahnrad mit 2 Haftringen Wheelset w. gear wheel w.2 tract.tyres	142149	12
18	Haftring N ab 8,5 mm 10 Stk. Set with traction tyres 10pieces	85610	10
19	TS - Kuppelstangen Part set of coupling rod	142983	18
20	Bosnakupplung kpl. BOSNA coupling complete	142203	6
21	Achse D=1,5 L=19,9 mm Axle D=1,5 L=19,9 mm	142156	5
22	Zurüstbeutel Bag of accessories	143679	18